



**Model Number**

**ML8-55-3476/102**

Retroreflective sensor  
with 2 m fixed cable

**Features**

- Cost-optimized series for standard tasks
- Miniature design
- DIN-connector
- Yellow LED indicator behind the front panel
- Flexible mounting possibilities due to slotted hole

**Product information**

Small, robust and reliable, the ML8 series of miniature sensors is particularly suitable for non-contact detection of objects in confined spaces. The LED indicator is located behind the lens and provides reliable information on the sensor's operating status. The LED is always visible, even if the sensor is completely embedded. Flexible mounting options and fixed preset detection ranges simplify setup and operation.

**Dimensions**

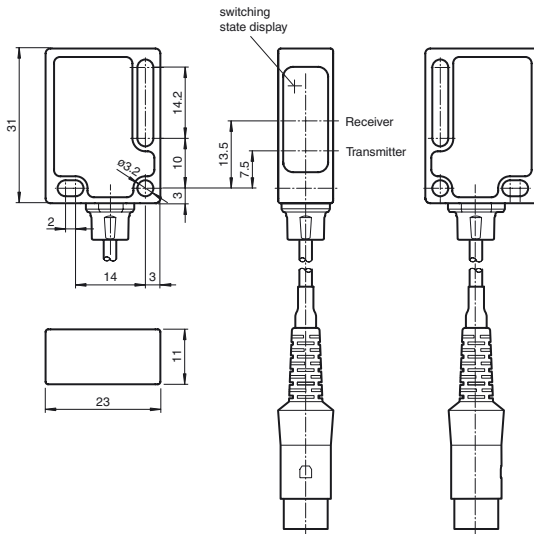

**Electrical connection**

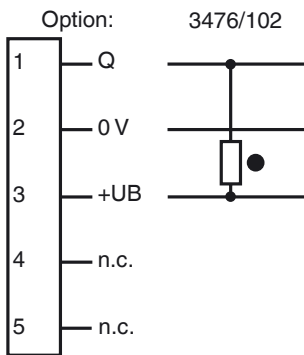

- = Light on
- = Dark on

**Indicators/operating means**

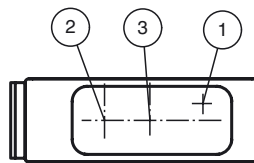

|   |                 |        |
|---|-----------------|--------|
| 1 | Switching state | yellow |
| 2 | Emitter         |        |
| 3 | Receiver        |        |

Release date: 2013-04-18 15:54 Date of issue: 2013-05-13 191826\_eng.xml

**Technical data****General specifications**

|                            |                                       |
|----------------------------|---------------------------------------|
| Effective detection range  | 0 ... 2.5 m                           |
| Reflector distance         | 0.02 ... 2.5 m                        |
| Threshold detection range  | 2.8 m                                 |
| Reference target           | H85-2 reflector                       |
| Light source               | LED                                   |
| Light type                 | modulated visible red light           |
| Diameter of the light spot | approx. 180 mm at a distance of 3.5 m |
| Angle of divergence        | approx. 3 °                           |
| Ambient light limit        | 40000 Lux                             |

**Functional safety related parameters**

|                                |        |
|--------------------------------|--------|
| MTTF <sub>d</sub>              | 2340 a |
| Mission Time (T <sub>M</sub> ) | 20 a   |
| Diagnostic Coverage (DC)       | 0 %    |

**Indicators/operating means**

|                  |                             |
|------------------|-----------------------------|
| Function display | LED yellow: switching state |
|------------------|-----------------------------|

**Electrical specifications**

|                        |                |                |
|------------------------|----------------|----------------|
| Operating voltage      | U <sub>B</sub> | 10 ... 30 V DC |
| Ripple                 |                | max. 10 %      |
| No-load supply current | I <sub>0</sub> | < 12 mA        |

**Output**

|                   |   |            |
|-------------------|---|------------|
| Switching type    | dark on   |            |
| Signal output     | 1 NPN, short-circuit protected, open collector, not protected from reverse polarity |            |
| Switching voltage | max. 30 V DC  |            |
| Switching current | max. 100 mA   |            |
| Voltage drop      | U <sub>d</sub>  | ≤ 1.5 V DC |
| Response time     |   | 1.8 ms     |

**Ambient conditions**

|                     |                                |
|---------------------|--------------------------------|
| Ambient temperature | -20 ... 60 °C (-4 ... 140 °F)  |
| Storage temperature | -40 ... 75 °C (-40 ... 167 °F) |

**Mechanical specifications**

|                   |   |
|-------------------|---|
| Protection degree | IP67  |
| Connection        | 2 m fixed cable with connector acc. to DIN 41524, 5-pin |
| Material          |   |
| Housing           | PC (glass-fiber-reinforced Makrolon)                    |
| Optical face      | PMMA  |
| Mass              | approx. 60 g  |

**Compliance with standards and directives**

|                      |                           |
|----------------------|---------------------------|
| Directive conformity | EMC Directive 2004/108/EC |
| Standard conformity  |                           |
| Product standard     | EN 60947-5-2:2007         |
| Protection degree    | EN 60529                  |
| Standards            | EN 50178, UL 508          |

**Approvals and certificates**

|              |  |
|--------------|--|
| UL approval  | cULus Listed, Class 2 Power Source, Type 1 enclosure         |
| CCC approval | CCC approval / marking not required for products rated ≤36 V |

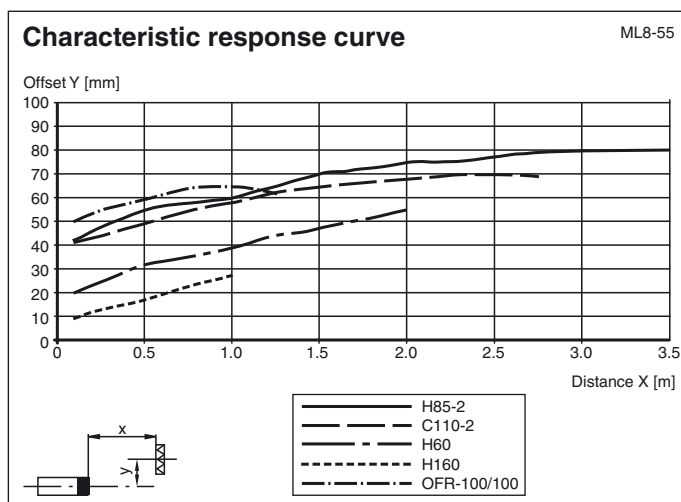
**Curves/Diagrams****Accessories****Montagekit OMH-ML7-01**

Mounting set consisting of bracket OMH-ML-01 sheet OMH-ML7-03, and fastening material

**Montagekit OMH-ML7-02**

Mounting set consisting of bracket OMH-ML-02 sheet OMH-ML7-03, and fastening material

**OMH-ML7-01**

Mounting bracket

**OMH-ML7-02**

Mounting bracket

**OMH-ML7-03**

Fixing plate

Other suitable accessories can be found at [www.pepperl-fuchs.com](http://www.pepperl-fuchs.com)

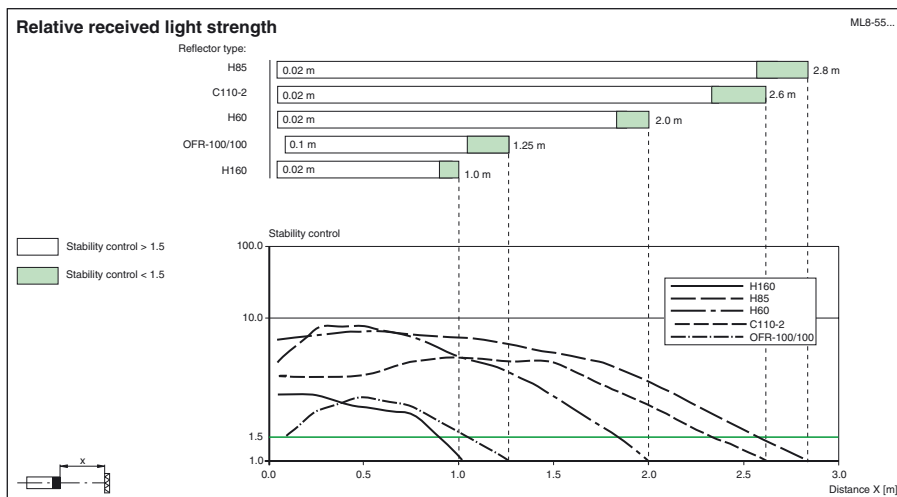

Release date: 2013-04-18 15:54 Date of issue: 2013-05-13 191826\_eng.xml

Refer to "General Notes Relating to Pepperl+Fuchs Product Information".

Pepperl+Fuchs Group  
www.pepperl-fuchs.com

USA: +1 330 486 0001  
fa-info@us.pepperl-fuchs.com

Germany: +49 621 776 4411  
fa-info@de.pepperl-fuchs.com

Singapore: +65 6779 9091  
fa-info@sg.pepperl-fuchs.com