



Model Number

M18-2500-RT-LAS-P/92

Laser pointer
with 4-pin, M12 x 1 connector

Features

- Visible red light, pulsed LASER light
- Laser class 1, eyesafe

Dimensions

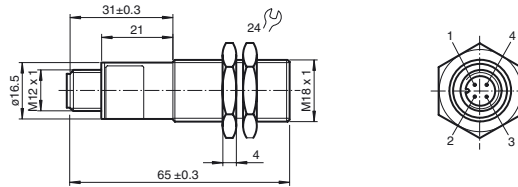

Electrical connection

Option: /92

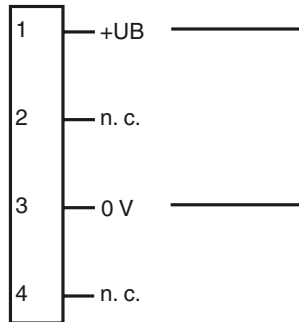

Pinout

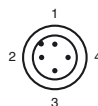

Wire colors in accordance with EN 60947-5-2

1	BN	(brown)
2	WH	(white)
3	BU	(blue)
4	BK	(black)

Release date: 2016-07-18 16:09 Date of issue: 2016-07-18 233999_eng.xml

Technical data**General specifications**

Effective detection range	0 ... 2.5 m
Threshold detection range	18 m
Light source	laser diode
Light type	modulated visible red light
Laser nominal ratings	
Note	LASER LIGHT , DO NOT STARE INTO BEAM
Laser class	1
Wave length	650 nm
Beam divergence	1.5 mrad
Pulse length	15 µs
Repetition rate	10 kHz
max. pulse energy	< 10.2 nJ
Diameter of the light spot	approx. 2.5 mm at detection range 2.5 m
Optical face	frontal

Functional safety related parameters

MTTF _d	520.4 a
Mission Time (T _M)	7 a
Diagnostic Coverage (DC)	0 %

Electrical specifications

Operating voltage	U _B	10 ... 30 V DC
Ripple		10 %
No-load supply current	I ₀	emitter ≤ 25 mA

Ambient conditions

Ambient temperature	0 ... 50 °C (32 ... 122 °F)
Storage temperature	-40 ... 85 °C (-40 ... 185 °F)

Mechanical specifications

Degree of protection	IP65
Connection	4-pin, M12 x 1 connector
Material	
Housing	brass, nickel-plated
Optical face	glass
Connector	metal
Mass	45 g

Compliance with standards and directives

Directive conformity	
EMC Directive 2004/108/EC	EN 60947-5-2:2007
Standard conformity	
Shock and impact resistance	IEC / EN 60068, half-sine, 30 g in X, Y and Z direction
Vibration resistance	IEC / EN 60068-2-6. Sinus. 10 -150 Hz, 5 g in each X, Y and Z directions
Laser class	IEC 60825-1:2007 EN 60825-1:2007

Approvals and certificates

CCC approval	CCC approval / marking not required for products rated ≤36 V
--------------	--

Laser notice laser class 1

- The irradiation can lead to irritation especially in a dark environment. Do not point at people!
- Maintenance and repairs should only be carried out by authorized service personnel!
- Attach the device so that the warning is clearly visible and readable.
- The warning accompanies the device and should be attached in immediate proximity to the device.
- Caution – Use of controls or adjustments or performance of procedures other than those specified herein may result in hazardous radiation exposure.

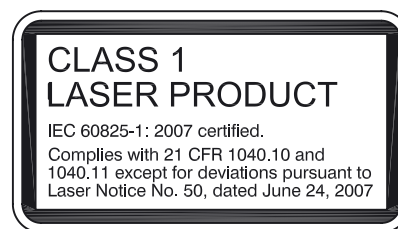
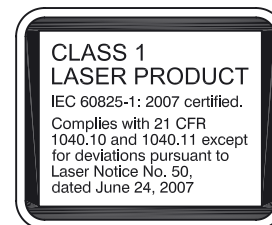
Laserlabel**Accessories****CPZ18B03**

Mounting Bracket with swivel nut

OMH-VL18

Mounting Bracket with swivel nut

BF 18

Mounting flange, 18 mm

BF 18-F

Mounting flange with dead stop, 18 mm

BF 5-30

Universal mounting bracket for cylindrical sensors with a diameter of 5 ... 30 mm

V1-G-2M-PVC

Female cordset, M12, 4-pin, PVC cable

V1-G-2M-PUR

Female cordset, M12, 4-pin, PUR cable

V1-W-2M-PUR

Female cordset, M12, 4-pin, PUR cable

V1-G-5M-PVC

Female cordset, M12, 4-pin, PVC cable

V1-G-5M-PUR

Female cordset, M12, 4-pin, PUR cable

V1-W-5M-PUR

Female cordset, M12, 4-pin, PUR cable

Other suitable accessories can be found at www.pepperl-fuchs.com